



Contact: LCRC (517)-546-4250

Construction Advisory
Whitmore Lake Road
Baytes Dr to Lee Rd

The following project is expected to be underway soon. As always, weather adversities, changes in contractor's schedules, or other factors could alter the timing described in this advisory. The Livingston County Road Commission will issue revised advisories for those projects with high traffic impacts.

Township: Green Oak Township
Roadway: Whitmore Lake Rd from Baytes Dr to Lee Rd
Starting Date: Monday, April 4, 2022 at **7:00 am**
Completion Date: Friday, October 28, 2022
Project Purpose: Reconstruction of Roadway
Traffic Impact: High Traffic Impact. **Starting at 7:00 am on Monday April 4th**, Traffic will be directed on Whitmore Lake Rd **ONE WAY ONLY** from Lee Rd south to Baytes Dr. See attached Sketch.

NO.	DATE	AUTH.	DESCRIPTION	NO.	DATE	AUTH.	DESCRIPTION
FINAL ROW/PLAN REVISIONS SUBMITTAL DATE:				TETRA TECH			
Livingston County Road Commission				NO SCALE			
FILE: WL_Detour_001.dgn				DATE: 11/19/21			
CS: 47000				JN: 213269			
MAINTAINING TRAFFIC DETOUR MAP				DRAWING SHEET			
WHITMORE LAKE RD				WHITLK SECT 1			
				MIDTR 001			
				34			

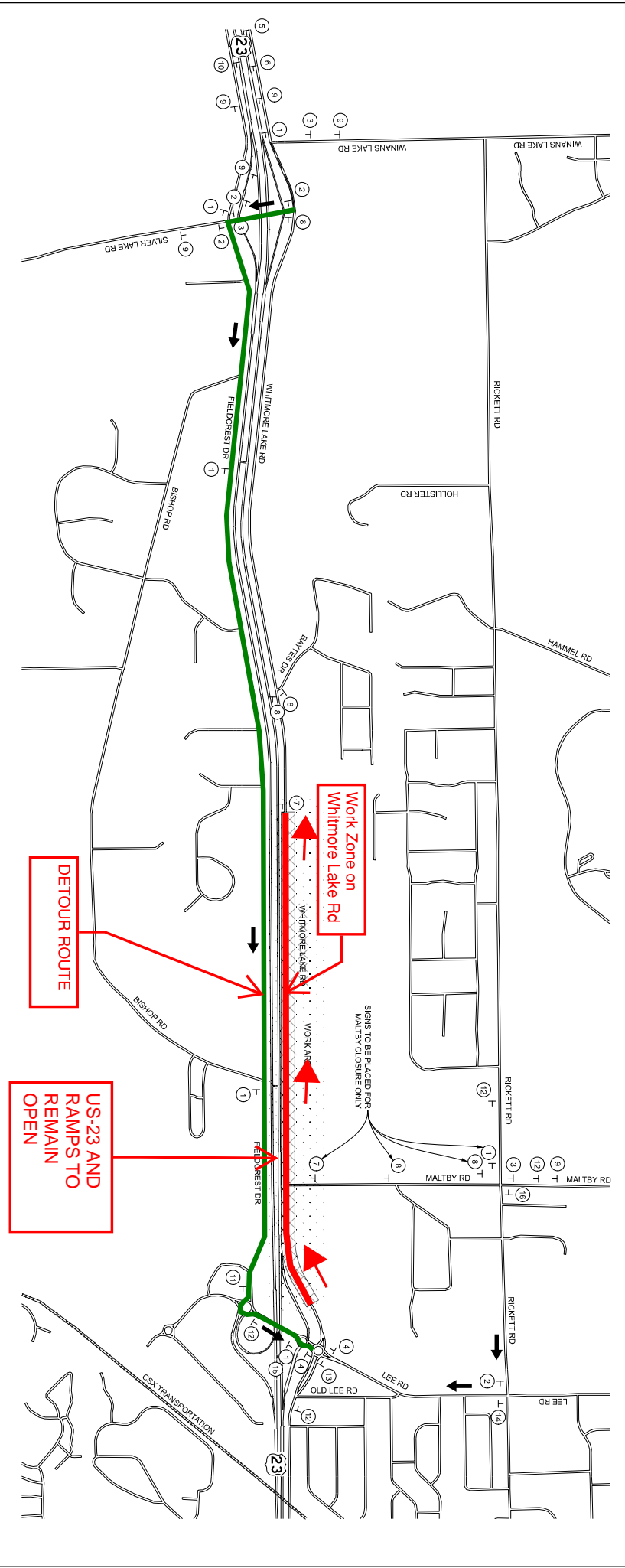

- SIGNS TO BE PLACED DURING MALTBY CLOSURE ONLY. SEE MAINTAINING TRAFFIC SPECIAL PROVISION FOR DETAILS.
- 1 **WHITMORE LK** SPECIAL SIGN #1
DETOUR M4-4 (30" X 24")
 - 2 **WHITMORE LK** SPECIAL SIGN #1
DETOUR M4-R (30" X 24")
 - 3 **WHITMORE LK** SPECIAL SIGN #1
DETOUR M4-L (30" X 24")
 - 4 **WHITMORE LK** SPECIAL SIGN #1
END DETOUR M4-8a (24" X 18")
 - 5 **WHITMORE LK** SPECIAL SIGN #1
DETOUR M5-3 (21" X 15")
 - 6 **WHITMORE LK** SPECIAL SIGN #1
DETOUR M4-4 (30" X 24")
 - 7 **WHITMORE LK** SPECIAL SIGN #1
DETOUR M4-4 (30" X 24")
 - 8 **WHITMORE LK** SPECIAL SIGN #1
DETOUR M4-4 (30" X 24")
 - 9 **WHITMORE LK** SPECIAL SIGN #2
SPECIAL SIGN #2
NB WHITMORE LK CLOSED
SILVER LK TO LEE
FOLLOW DETOUR
 - 10 **WHITMORE LK** SPECIAL SIGN #3
SPECIAL SIGN #3
NB WHITMORE LK CLOSED
SILVER LK TO LEE
SEEK ALT RTE
 - 11 **WHITMORE LK** SPECIAL SIGN #1
DETOUR M4-8
M5-3 (21" X 15")
 - 12 **MALTBY** SPECIAL SIGN #5
SPECIAL SIGN #5
MALTBY CLOSED AT
WHITMORE LK RD
FOLLOW DETOUR
 - 13 **MALTBY** SPECIAL SIGN #5
SPECIAL SIGN #5
DETOUR M4-R (30" X 24")
 - 14 **MALTBY** SPECIAL SIGN #5
SPECIAL SIGN #5
DETOUR M4-L (30" X 24")
 - 15 **MALTBY** SPECIAL SIGN #5
SPECIAL SIGN #5
DETOUR M4-4 (30" X 24")
 - 16 **MALTBY** SPECIAL SIGN #5
SPECIAL SIGN #5
DETOUR M4-4 (30" X 24")
 - 17 **MALTBY** SPECIAL SIGN #5
SPECIAL SIGN #5
DETOUR M4-4 (30" X 24")
 - 18 **MALTBY** SPECIAL SIGN #5
SPECIAL SIGN #5
DETOUR M4-4 (30" X 24")
 - 19 **MALTBY** SPECIAL SIGN #5
SPECIAL SIGN #5
DETOUR M4-4 (30" X 24")